

MATERIALS HOIST

**GEDA 500 Z/ZP
& 1500 Z/ZP**

24m/min



GEDA 500 Z/ZP

Materials Hoist



GEDA products have been sold in 80 different countries around the world. In addition to our subsidiaries in Germany, Russia, the USA and Turkey, our comprehensive dealer network plays a huge part in our worldwide success. GEDA is represented both in Europe and in the Pacific region through skilled professional dealers who are responsible both for sales and service in their local areas.

GEDA 500 Z/Z

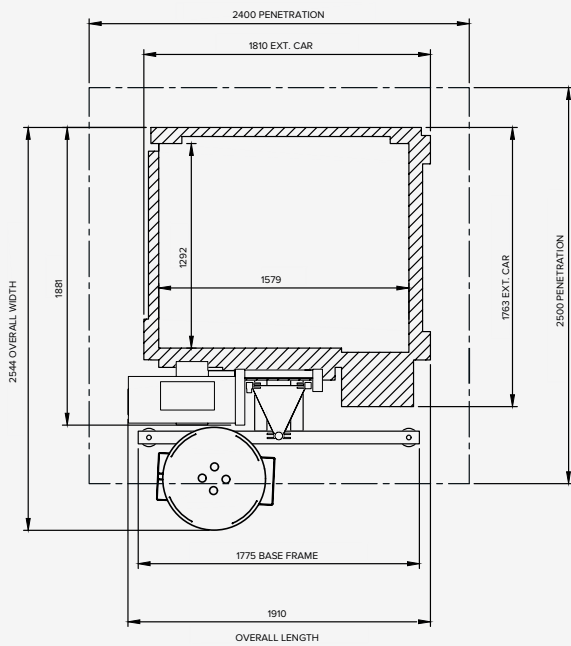

PLAN VIEW

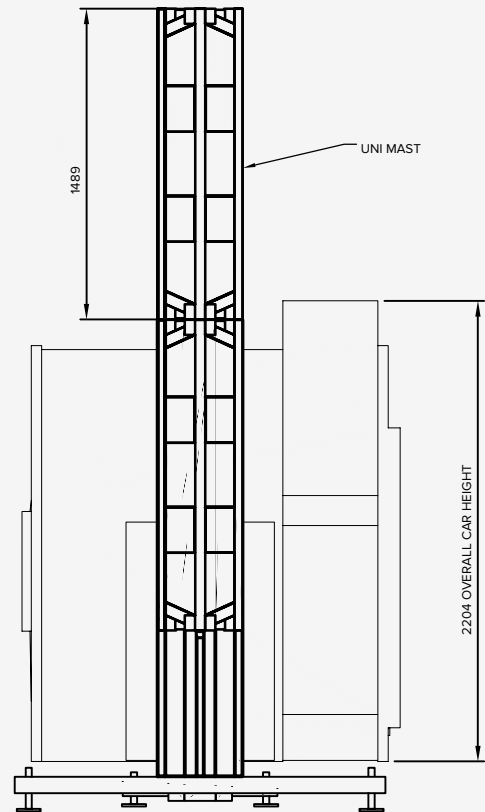

ELEVATION VIEW

TECHNICAL DATA

GEDA 500 Z/ZP

CAPACITY

Payload	850 kg
Lifting Speed	24 m/min
Maximum Lifting Height	100m
Noise Level	<78 dB(A)
Operation Temperature	-20°C..+40°C
Counter Weight	No

ELECTRICAL DATA

Motor	1 x 3.0/6.1 kw / 16 A
Power Supply	3-ph / 400 V / 50 Hz
230 V Power on Platform	Standard, included
Max. Starting Current (A)	60A
Overload device	Standard, included
Automatic lubrication	Standard, included

DIMENSIONS & WEIGHT

Platform "A" Internal Dimensions (L x W)	1.579 x 1.292 m
Base Frame Dimensions (L x W)	1.775 x 1.482 m
Overall Dimensions (L x W)	1.910 x 2.544 m
Base Frame with Platform Weight	1000 kg
Mast section Length	1.5m
Mast section Weight	48 kg

HOIST CONTROLS

Manual controls / erection controls	Standard, included
Drop test controls	Standard, included
Programmable landings	Optional
Hoist calling system	Optional

GENERAL

Finishing Cabin / Ground Enclosure	Galvanised / Powder Coated
Company Logo & Colour	Optional
Ground Enclosure	Optional
Cable System	Basket
Erection Jib	Optional
Norms & Regulations	European Machine Directive CE 2006/42 EC Australian Standard

GEDA 1500 Z/ZP

Materials Hoist



GEDA 1500 Z/ZP

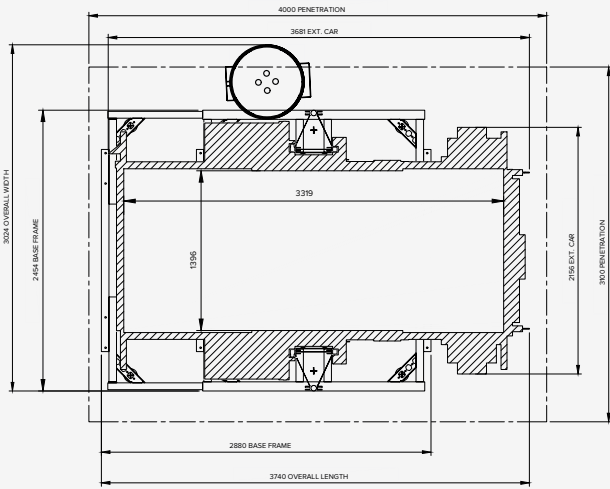

PLAN VIEW

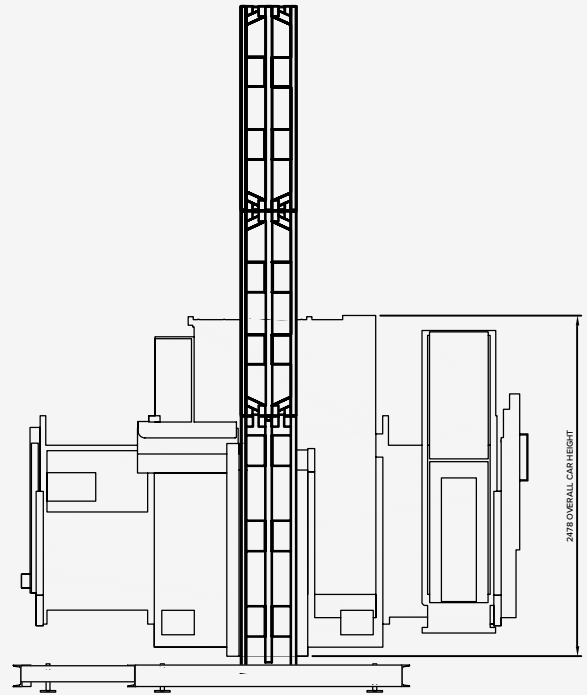

ELEVATION VIEW

TECHNICAL DATA

GEDA 1500 Z/ZP

CAPACITY

Payload	2000 kg
Lifting Speed	24 m/min
Maximum Lifting Height	100m
Noise Level	<78 dB(A)
Operation Temperature	-20°C..+40°C
Counter Weight	No

ELECTRICAL DATA

Motor	2 x 3.0/6.1 kW / 32 A
Power Supply	3-ph / 400 V / 50 Hz
230 V Power on Platform	Standard, included
Max. Starting Current (A)	60A
Overload device	Standard, included
Automatic lubrication	Standard, included

DIMENSIONS & WEIGHT

Platform "BS" Internal Dimensions (L x W)	3.319 x 1.396 m
Base Frame Dimensions (L x W)	2.880 x 2.454 m
Overall Dimensions (L x W)	3.740 x 3.024 m
Base Frame with Platform Weight	1580 kg
Mast section Length	1.5m
Mast section Weight	48 kg

HOIST CONTROLS

Manual controls / erection controls	Standard, included
Drop test controls	Standard, included
Programmable landings	Optional
Hoist calling system	Optional

GENERAL

Finishing Cabin / Ground Enclosure	Galvanised / Powder Coated
Company Logo & Colour	Optional
Ground Enclosure	Optional
Cable System	Basket
Erection Jib	Optional
Norms & Regulations	European Machine Directive CE 2006/42 EC Australian Standards



43 Dunmore Drive, Truganina VIC 3029 Australia

 +61 3 9116 4090  sales@standardaccess.com.au  www.standardaccess.com.au