

MAST CLIMBER
Glide Rail

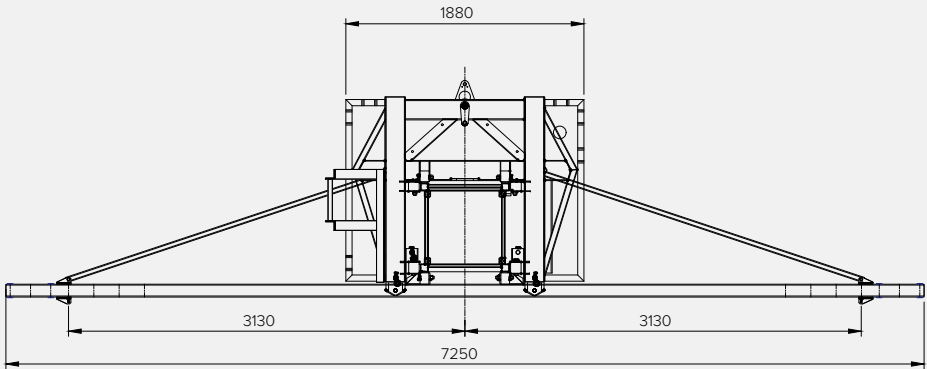

Glide Rail

Mast Climber



PLAN VIEW

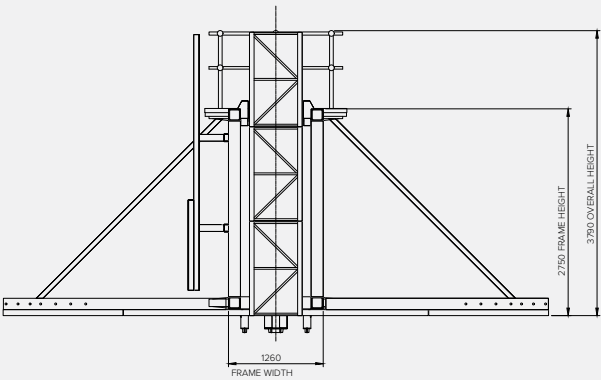

ELEVATION VIEW

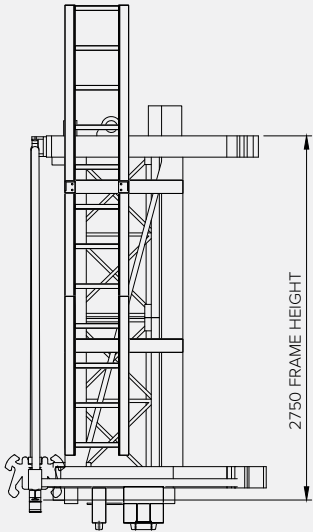

SIDE VIEW

Glide Rail

Mast Climber

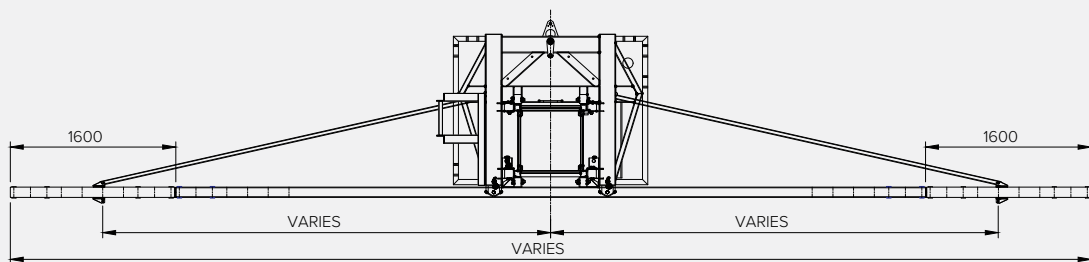

SINGLE GLIDE RAIL / MONORAIL



TWIN GLIDE RAIL / MONORAIL

SCANCLIMBER®

SCANCLIMBER is the world's technology leader in mast climbing equipment for both temporary and permanent installations. The company has its corporate head office in Pirkkala, Finland and manufacturing in Gniezno, Poland. The company employs more than 200 staff in Europe and Asia. Scanclimber creates value for its customers with high quality, reliable and flexible vertical access solutions.

Technical Data Glide Rail

Payload	600 kg max
Frame Height	2750 mm
Frame Width	1260 mm
Distance from Wall	145 - 1145 mm
Free Standing	Not allowed
Operation Temperature	-30°C to +40°C
Maximum Width	Single Platform: 16.9 m Twin Platform: 38.2 m
Applicable Mast Climber	SC5000, SC6000, SC8000, SC10000

SPECIAL FEATURES

Self-climbs with the mast climber

Can be position (locked off) at any vertical location on mast

*Data based on a standard configuration