

MATERIALS HOIST

GEDA 1500 Z/ZP

24m/min



PLAN VIEW

GEDA 1500 Z/ZP

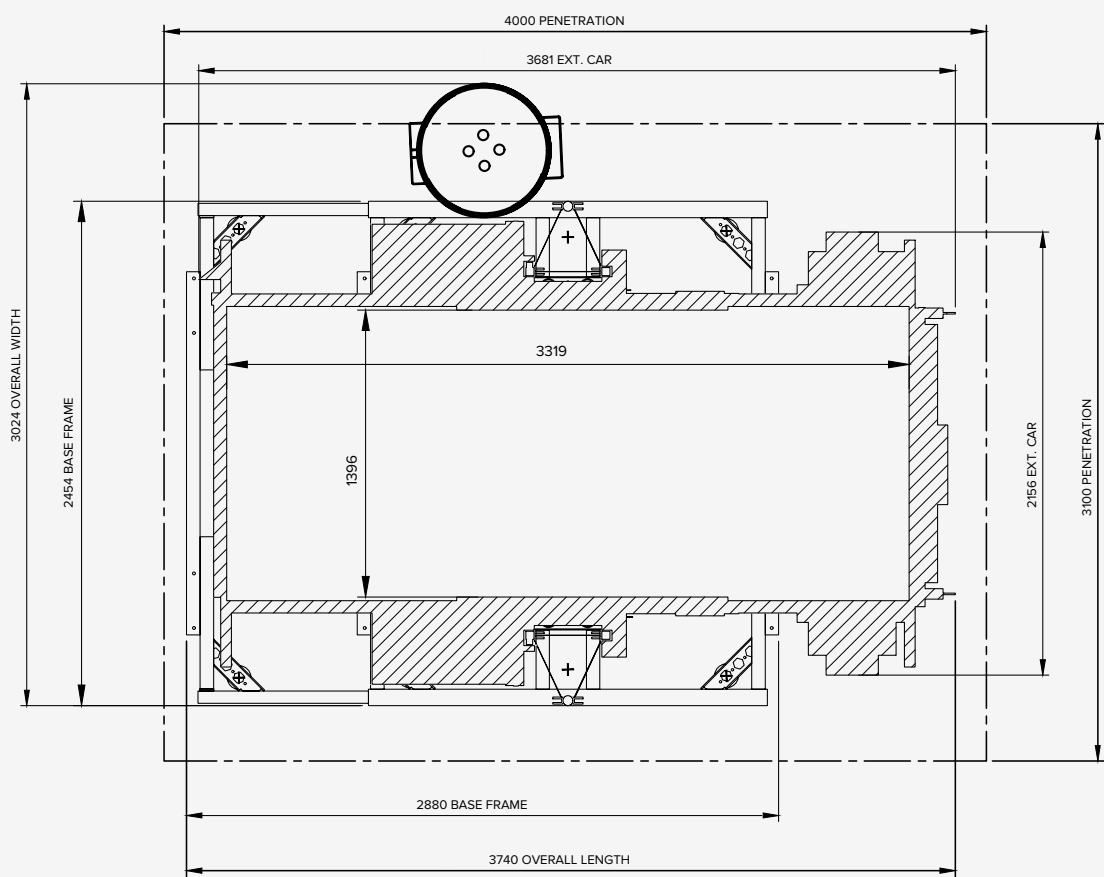

PLAN VIEW

ELEVATION VIEW

GEDA 1500 Z/ZP

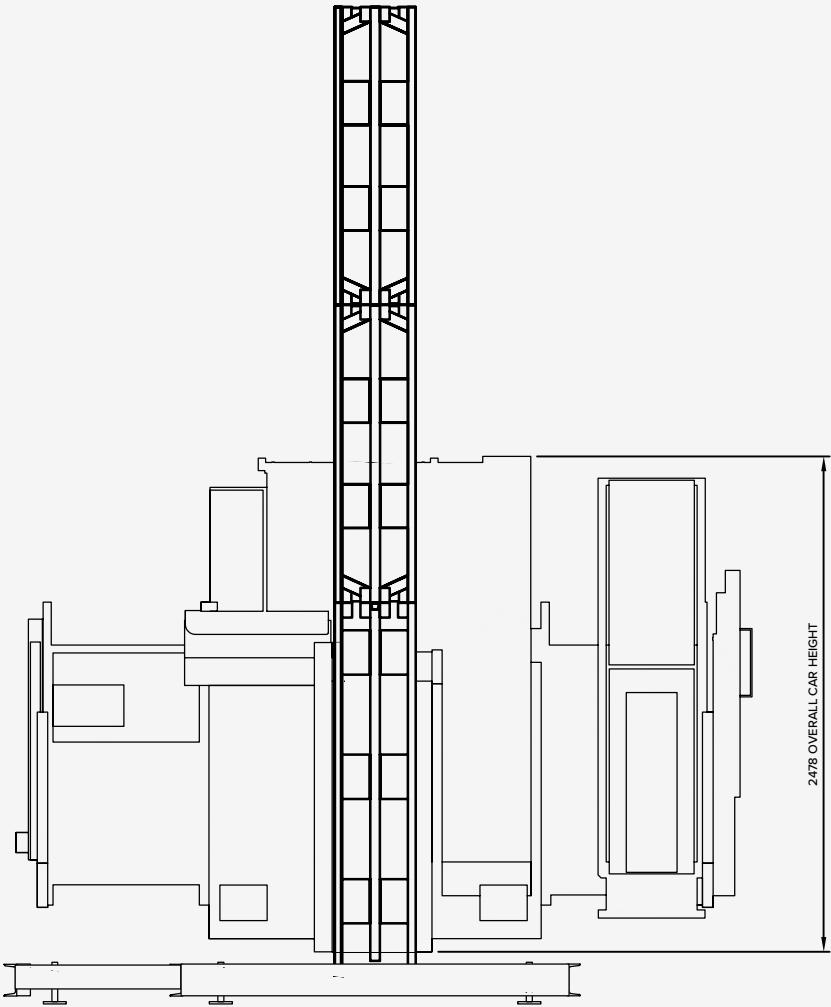

ELEVATION VIEW

GEDA products have been sold in 80 different countries around the world. In addition to our subsidiaries in Germany, Russia, the USA and Turkey, our comprehensive dealer network plays a huge part in our worldwide success. GEDA is represented both in Europe and in the Pacific region through skilled professional dealers who are responsible both for sales and service in their local areas.

Technical Data

GEDA 1500 Z/ZP

CAPACITY

| | |
|------------------------|--------------|
| Payload | 2000 kg |
| Lifting Speed | 24 m/min |
| Maximum Lifting Height | 100m |
| Noise Level | <78 dB(A) |
| Operation Temperature | -20°C..+40°C |
| Counter Weight | No |

ELECTRICAL DATA

| | |
|---------------------------|-----------------------|
| Motor | 2 x 3.0/6.1 kW / 32 A |
| Power Supply | 3-ph / 400 V / 50 Hz |
| 230 V Power on Platform | Standard, included |
| Max. Starting Current (A) | 60A |
| Overload device | Standard, included |
| Automatic lubrication | Standard, included |

DIMENSIONS & WEIGHT

| | |
|---|-----------------|
| Platform "BS" Internal Dimensions (L x W) | 3.319 x 1.396 m |
| Base Frame Dimensions (L x W) | 2.880 x 2.454 m |
| Overall Dimensions (L x W) | 3.740 x 3.024 m |
| Base Frame with Platform Weight | 1580 kg |
| Mast section Length | 1.5m |
| Mast section Weight | 48 kg |

HOIST CONTROLS

| | |
|-------------------------------------|--------------------|
| Manual controls / erection controls | Standard, included |
| Drop test controls | Standard, included |
| Programmable landings | Optional |
| Hoist calling system | Optional |

GENERAL

| | |
|------------------------------------|--|
| Finishing Cabin / Ground Enclosure | Galvanised / Powder Coated |
| Company Logo & Colour | Optional |
| Ground Enclosure | Optional |
| Cable System | Basket |
| Erection Jib | Optional |
| Norms & Regulations | European Machine Directive CE 2006/42 EC Australian Standards |